

Courses & Dist^s of River
Beg at Beech

N 70 E 14
N 62½ E 24
N 57½ E 76
N 46 E 14
N 39 E 36
N 61 E 12 to Sugar tree
176

Courses & dist^s of River
Beg. at W.O.

N 4 E 33
N 20½ E 20
N 33 E 34
N 39 E 10
97

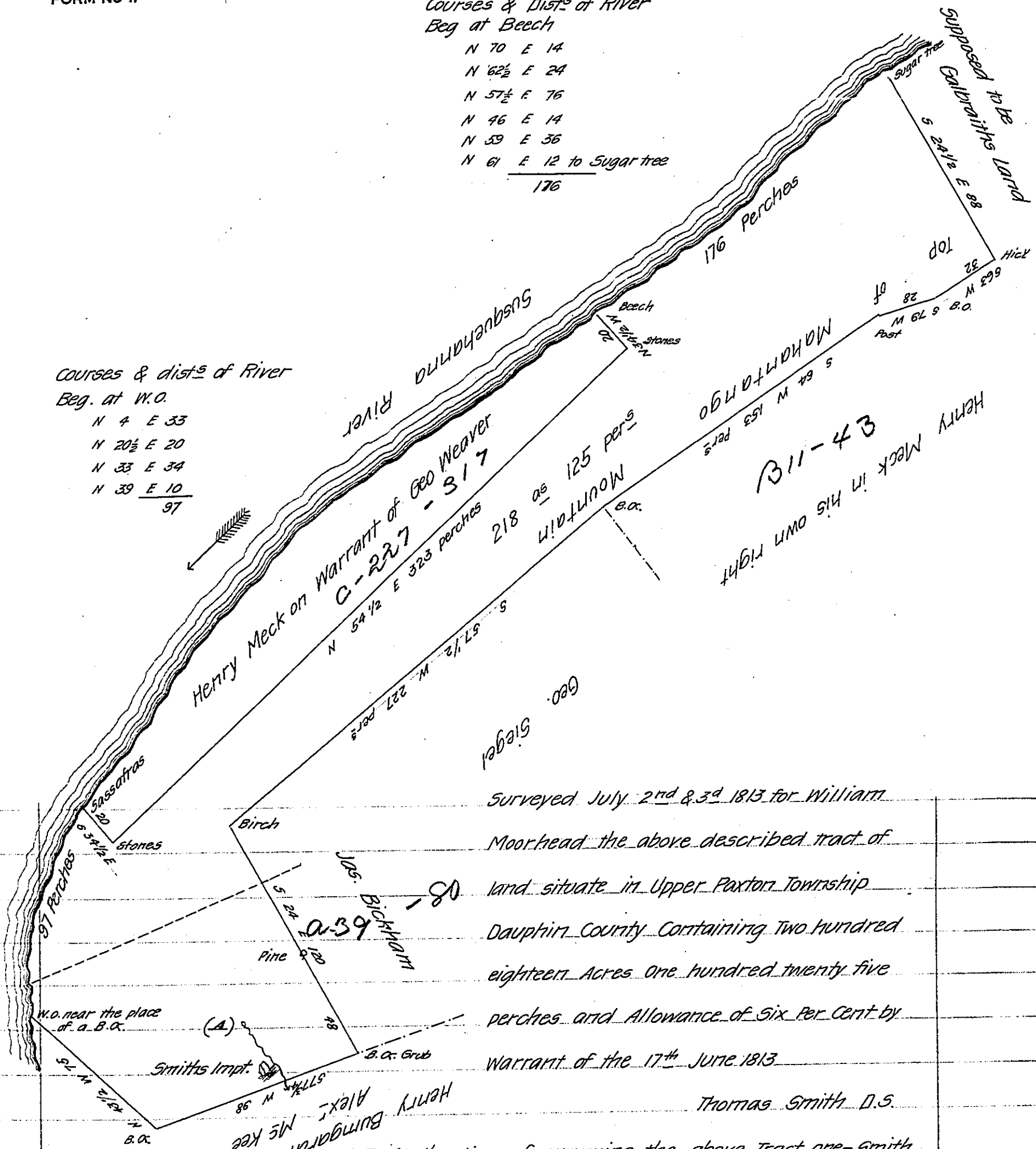

Surveyed July 2nd & 3^d 1813 for William

Moorhead the above described tract of

land situate in Upper Paxton Township

Dauphin County Containing Two hundred

eighteen Acres One hundred twenty five

perches and Allowance of Six Per Cent by

Warrant of the 17th June 1813

Thomas Smith D.S.

N.B. At the time of surveying the above Tract one - Smith and his family were actually settled and residing on the ~~above des-~~

~~cribed tract~~ near to the letter (A) which part is also claimed as far as to the dotted line by the heirs of James Bickham dec'd by warrant of the 3^d June 1774

To Richard T. Leech Esquire

T.S.

Surveyor General Pa

IN TESTIMONY that the above is a copy of the original remaining on file in the Department of Internal Affairs of Pennsylvania, made conformably to an Act of Assembly approved the 16th day of February, 1833, I have hereunto set my Hand and caused the Seal of said Department to be affixed at Harrisburg, this third day of October 1907

Henry Howell
Secretary of Internal Affairs.